



5599 Highway 31 West
Portland, TN 37148
(615) 325-2774

ETC-UA-12HD

Pg.1 . TITLE PAGE Pg.3 . ETC-UA-12HD BOM

Pg.2 . ETC-UA-12HD

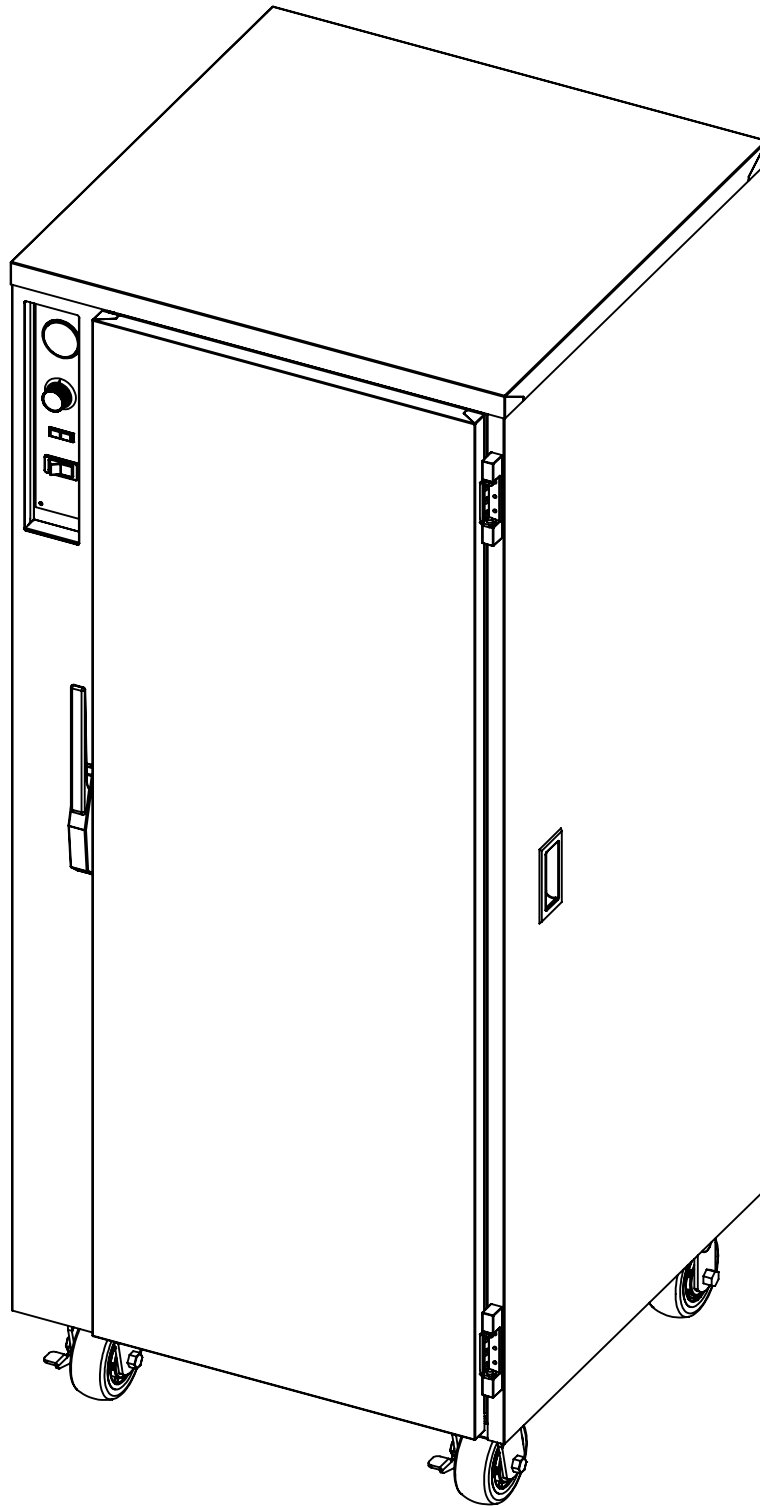

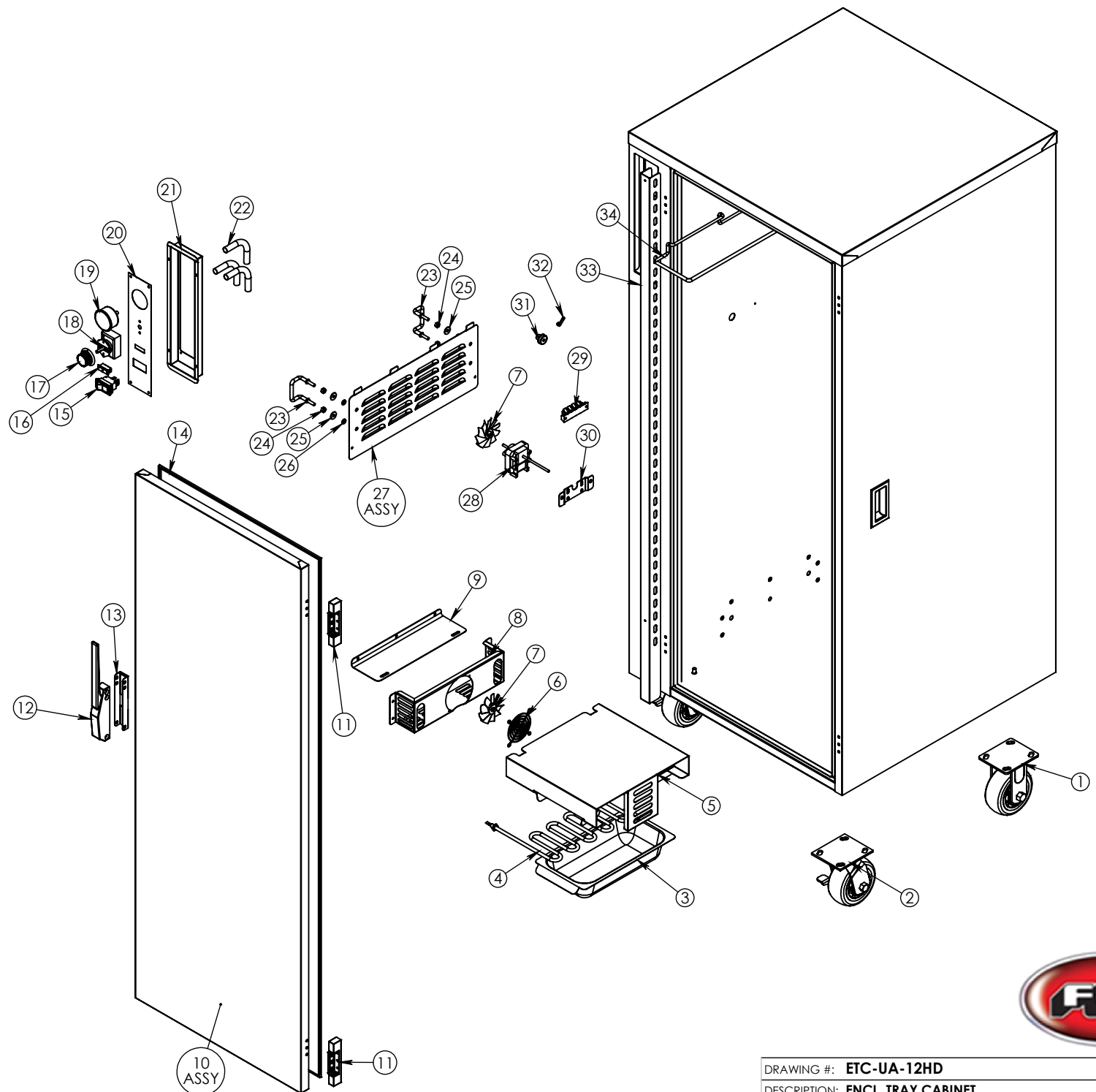

DRAWING #: **ETC-UA-12HD**

DESCRIPTION: **ENCL. TRAY CABINET**

DRAWN BY: AL

LAST SAVED BY: andrew82

ITEM NO.	QTY.	PART NO.	DESCRIPTION
1	2	CSTR 52-R-PPF	CASTER 5" RIGID EZ ROLL POLY
2	2	CSTR 52-SB-PPF	CASTER 5" SWIVEL BRAKE EZ ROLL POLY
3	1	WATER-PAN-3RD-WHDL	WATER PAN 2.5" X6.75 X
4	2	EL1500-220HT	ELEMENT 1500 WATT 220 VOLT 8" HT
5	1	58408	HEAT SHIELD USE WITH H2O PAN
6	1	GRD FAN	FAN GUARD
7	2	BLD FAN AL	FAN BLADE 3" ALUMINUM
8	1	4011	HUMITEMP BLOWER HOUSING
9	1	4041	HUMITEMP BLOWER LID
10	1	Z-301-4659(INCLUDES 11-13)	ETC-UA-12HD DOOR ASSY EDG/EDG RH-FR
11	2	HNG-214	DOOR HINGE EDGEMOUNT .875"
12	1	LTH-DR	DOOR LATCH EDGEMOUNT STYLE CHROME
13	1	81004	LTH-DR LATCH COVER NSF
14	1	GSKT-D-61-4375X22-312	SILICONE DR GASKET D 61.4375X22.31
15	1	SWH RCK HY60	SWITCH NON-LT ON/OFF ROCKER BLK
16	1	LT PLT A-G 250	INDICATOR LIGHT AMBER GREEN 250V
17	1	KNB H6	KNOB WITH ARROW
18	1	T-STAT H1	THERMOMSTAT HEAT CONTRL 90-190 36"
19	1	T-METER H1	THERMOMETER 100-220
20	1	CNTRL-PNL-HUMI-TEMP-AL	ALUM PANEL FOR HUMI-TEEMP
21	1	57710	RECESS CONTROL HOUSING
22	3	SLV-ACRYLIC-WHITE-7-16	SLEEVING ACRYLIC 7/16 ID WHITE FAI
23	2	BRK CRD 1	BRACKET CORD WINDING
24	4	N1-4-20HXS	1/4-20 HX NUT,SS
25	4	W75X1-4X1-16	3/4ODX1/4IDX1/16 FLAT WASHER, 18-8
26	4	W1-4SLSS	WASHER1/4 MED.SPLIT LK SS
27	1	Z-600-2316 (INCLUDES 23-26)	HUMITEMP LOUVER PANEL W/TABS
28	1	MTR BY220 93	MOTOR DUAL SHAFTED 220 VOLT
29	1	TRM 4QC	TERMINAL BLOCK 4QC
30	1	80610	BRACKET MOTOR MNT FOR BAY MTR
31	1	BSH .75 LIQUID TIGHT	LIQUID TIGHT BUSHING 3/4 HOLE SIZE
32	2	CLP-AL1-4	CLAMP 1-4" ALUM
33	2	Z-600-3953	ETC-UA-12 RACK CROSS CHANNEL ASSY
34	24	SLD UHS245	TRAY SLIDE NICKEL PLATED UHS



DRAWING #: **ETC-UA-12HD**

DESCRIPTION: **ENCL. TRAY CABINET**

DRAWN BY: AL

LAST SAVED BY: andrew82