



5599 Highway 31 West
Portland, TN 37148
(615)325-2774

P-144

Pg.1 . TITLE PAGE

Pg.3 . P-144 BOM

Pg.2 . P-144 EXPLODED

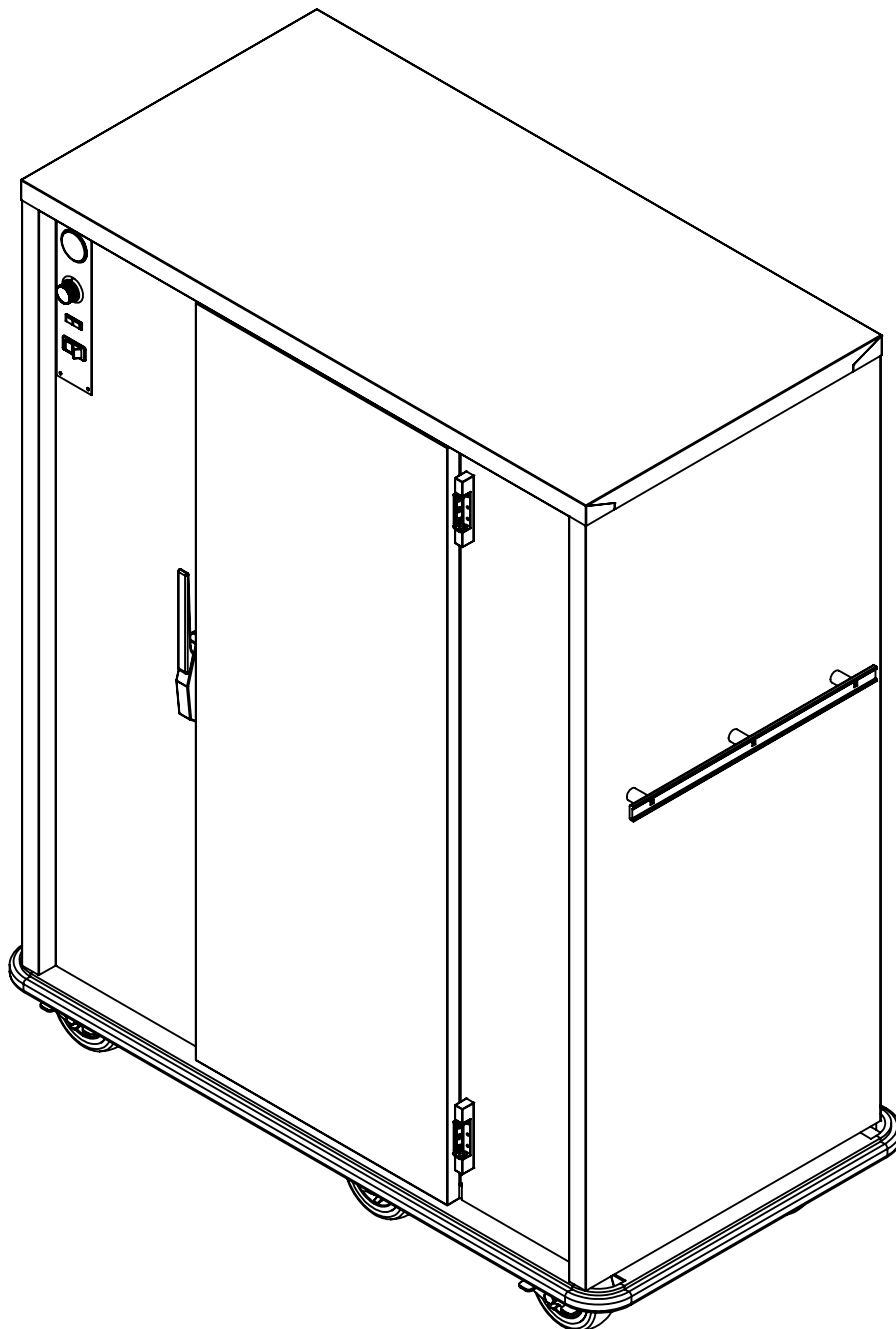

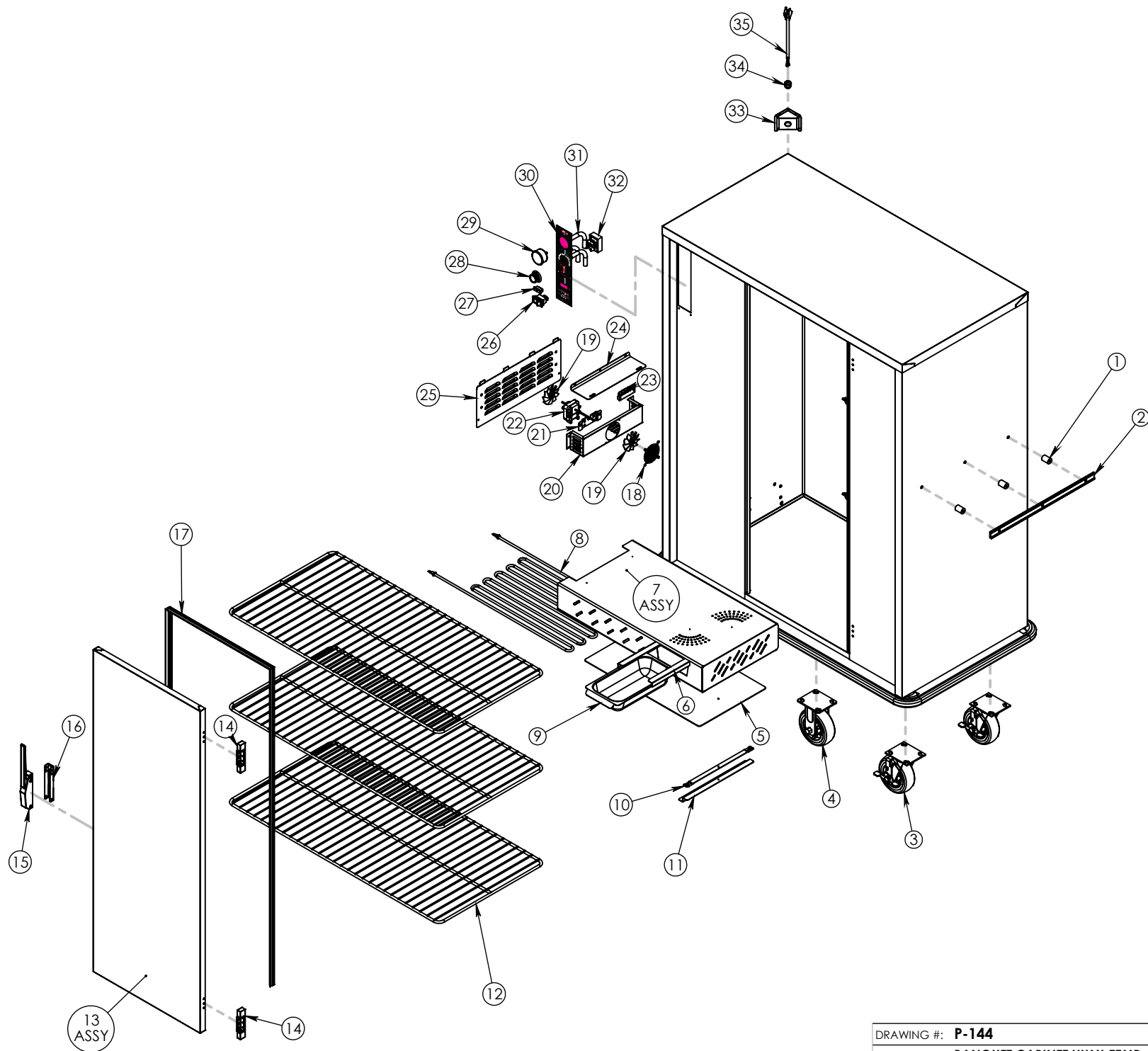

DRAWING #: P-144	
DESCRIPTION: BANQUET CABINET HUMI-TEMP	
DRAWN BY: DP	LAST SAVED BY: dplodzien

ITEM NO.	QTY.	PART NO.	DESCRIPTION
1	6	SPCR125X.330	HANDLE SPACERS FOR HDL 21 AND 12.
2	2	HDL-215-AL	HANDLE PUSH AL 21.5
3	4	CSTR 52-SB-PPF	CASTER 5" SWIVEL BRAKE EZ ROLL POLY
4	2	CSTR 52-R-PPF	CASTER 5" RIGID EZ ROLL POLY
5	1	50300	ALUM HTNG ELEMENT CVR
6	2	5956	WATER PAN TUNNEL CHANNELS
7	1	Z-600-1241 (INCLUDES 6 & 9)	WATER PAN TUNNEL ASSEMBLY
8	1	EL1600-220HT-XL-28	ELEMENT 1600 WATT 220 VOLT 28" HT
9	1	WATER-PAN-3RD-WHDL	WATER PAN 2.5" X6.75 X
10	1	5958	1600W ELEMENT BRACKET STRAP
11	1	50634	ELEMENT HOLDER BRKT
12	3	SHLF-P120	SHELF 22.25X44.25"
13	1	Z-301-3936 (INCLUDES 14-16)	DOOR ASSY EDG/EDG PRESS IN RH
14	2	HNG-214	DOOR HINGE EDGEMOUNT .875"
15	1	LTH-DR	DOOR LATCH EDGEMOUNT STYLE CHROME
16	1	81004	LTH-DR LATCH COVER NSF
17	1	GSKT-D-57-218X21-812	SILICONE DR GASKET D 48.062X21.812
18	1	GRD FAN	FAN GUARD
19	2	BLD FAN AL	FAN BLADE 3" ALUMINUM
20	1	5345	HUMITEMP BLOWER HSING
21	1	80610	BRACKET MOTOR MNT FOR BAY MTR
22	1	MTR BY120 92	MOTOR DUAL SHAFTED 120 VOLT
23	1	TRM 4QC	TERMINAL BLOCK 4QC
24	1	4041	HUMITEMP BLOWER LID
25	1	53454	HUMITEMP LOUVER PANEL W/TABS
26	1	SWH RCK E1	SWITCH NON-LT ROCKER 125/250V 20AMP
27	1	LT PLT A-G	INDICATOR LIGHT AMBER GREEN 125V
28	1	KNB H6	KNOB WITH ARROW
29	1	T-METER H1	THERMOMETER 100-220
30	1	CNTRL-PNL-HUMI-TEMP-AL	ALUM PANEL FOR HUMI-TEMP
31	1	SLV-ACRYLIC-WHITE-7-16 @ 25"	SLEEVING ACRYLIC 7/16 ID WHITE FAI
32	1	T-STAT H1	THERMOMSTAT HEAT CONTRL 90-190 36"
33	1	69730	HUMI TRI-CORD BRCKET DD .770X .875
34	1	BSH STRN 4	STRAIN RELIEF FOR 20 AMP CORD
35	1	CRDSET20-115	CORD 12' 115 VOLT 5-20P 12GA 3 WIRE

DRAWING #: **P-144**

DESCRIPTION: **BANQUET CABINET HUMI-TEMP**

DRAWN BY: DP

LAST SAVED BY: dplodzien