



5599 Highway 31 West  
Portland ,TN 37148  
(615)325-2774

# RH-18

Pg.1 .....Title Page

Pg.3 .....RH-18 BOM

Pg.2 .....RH-18  
EXPLODED

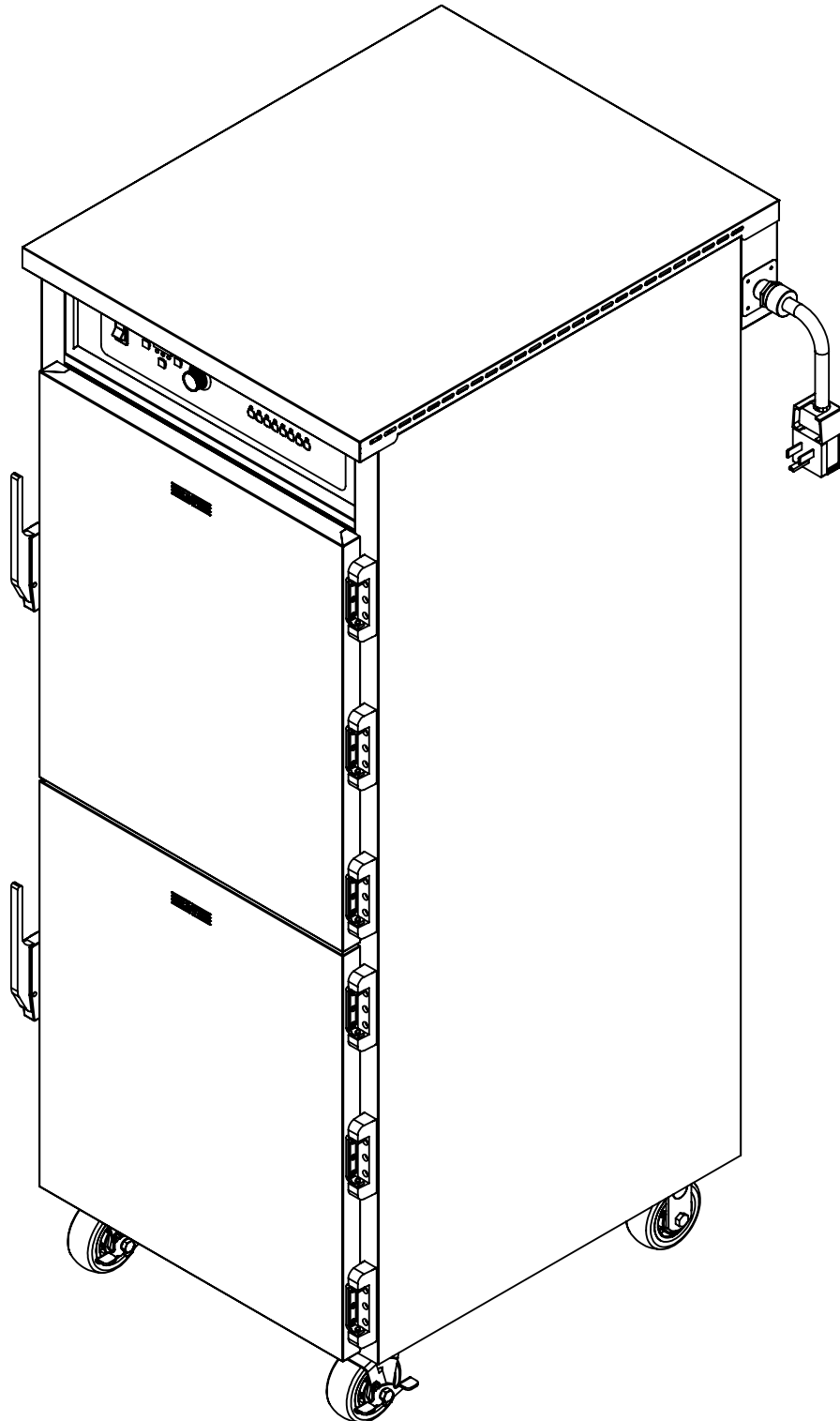

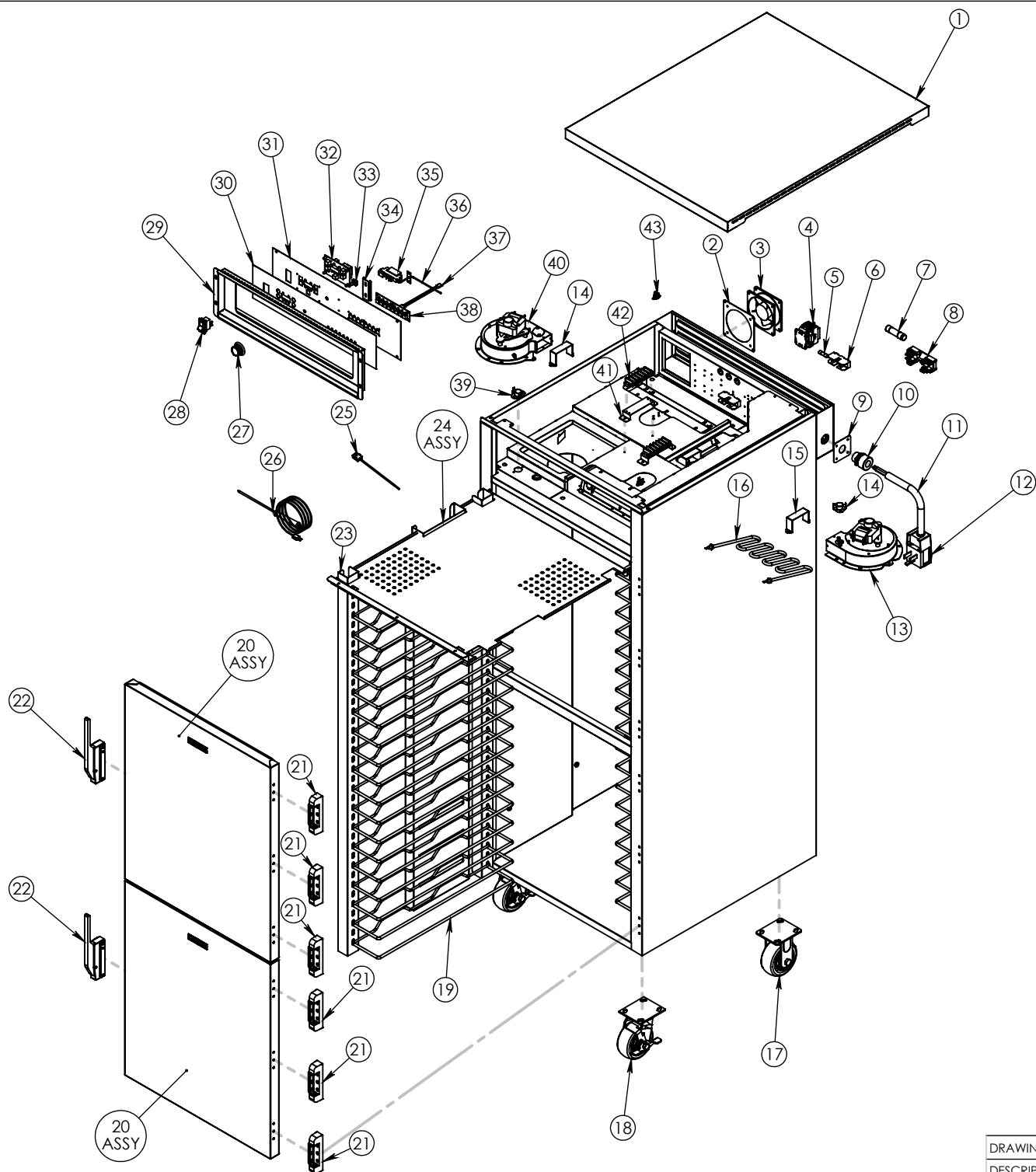

DRAWING #: **RH-18**

DESCRIPTION: **RE-THERM AND HOLD OVEN**

DRAWN BY: DP

LAST SAVED BY: dplodzien

ITEM NO.	QTY.	PART NO.	DESCRIPTION
1	1	22211	OUTSIDE TOP VENTED
2	2	52840	BRACKET MOTOR MNT FAN BLOW
3	1	FAN BLOW RTH	COOLING FAN MOTOR TUBE AXIAL 220V
4	2	CONTACT-2POLE-50 AMP RES	CONTACTOR 2 POLE 50AMP RESISTIVE
5	2	FS-LP-MID-10AMP	FUSE 10 AMP LOW PEAK MIDGET
6	2	FSHLDR-MID-30-1	FUSE HOLDER 30 AMP MIDGET
7	2	FS 60 LCH-RH	FUSE 60 AMP/250V
8	2	FSHLDR-60AMP	FUSE BLOCK 60 AMP
9	1	58031	CORD GRIP ADAPTOR PLATE 3-4-7-8
10	1	CRD GRIP 6-4	CORD GRIP 1-IN .875-1 CONN
11	1	CRD 6/3	CORD SO 6-3 BLK - 250R
12	1	PLG LTO	PLUG 50A/250VHBL#9368 6-50P
13	1	Z-600-2040	MOTOR BLWR ASSEM 115/230 REV SNAP
14	1	SNAP DISC 150-130	COOL DOWN SNAP DISC F150 OPEN RISE
15	2	53916	BLOWER END SEAL CAP
16	6	EL1500-220HT	ELEMENT 1500 WATT 220 VOLT 8" HT
17	2	CSTR 52-R-PPF	CASTER 5" RIGID EZ ROLL POLY
18	2	CSTR 52-SB-PPF	CASTER 5" SWIVEL BRAKE EZ ROLL POLY
19	36	SLD RH 245	TRAY SLIDE NICKEL PLATED RH
20	2	Z-301-1672 (INCLUDES PARTS 21 & 22)	DOOR ASSY 3EDG/MAG VENTED RH
21	6	HNG-217	DOOR HINGE EDGEMOUNT 1.375" REF
22	2	LTH DR MAG-RH	DOOR LATCH EDGEMOUNT BLACK MAGNETIC
23	4	53927	UPRIGHT
24	2	Z-600-4283	BOTTOM HEAT COVER ASSY 3 ELMT
25	1	PRB RTD 36	RTD THERMOCOUPLE ASSY 36"
26	1	PRB MT RTD	RTD MEAT PROBE
27	1	KNB H6 SS	KNOB WITH ARROW AND SET SCREW
28	1	SWH RCK E1	SWITCH NON-LT ROCKER 125/250V 20AMP
29	1	57365	CONTROL PANEL
30	1	CNTRL PNL S-RH-PRGM	OVERLAY SINGLE CAVITY PROGRAM
31	1	82451	M WAVE CONTROL PANEL 120V
32	1	CNTRL BRD LCH PRGM 240	CONTROL BOARD PROGRAMABLE 240VLCH
33	1	CNTRL PNL ENCODER	ENCODER FOR LCH CONTROLLER
34	1	81562	DIN RAIL 3.00
35	1	RLY 12	SSR OP 12V
36	1	PRB RTD	RTD TEMPERATURE PROBE
37	1	CBL LCH 17	CNTRL BRD LCH PRGM CABLE 17"
38	1	CNTRL BRD LCH PRGM 8	8 BUTTON PREST CNTRL BRD W 8 GR LED
39	1	SNAP DISC 210-250	HI-LIMIT SWITCH NC
40	1	Z-600-2065	MOTOR BLWR ASSEM 115/230 REV
41	2	50368	BRKT TRM BLOCK 6 GANG
42	2	TRM BLK RTH	TERMINAL BLOCK -6 POLES
43	2	HI-LIMIT 500 DEG	HI-TEMP SNAP DISC 500 DEG. F



DRAWING #: **RH-18**

DESCRIPTION: **RE-THERM AND HOLD OVEN**

DRAWN BY: DP

LAST SAVED BY: dplodzien